

FOR REFERENCE ONLY

REVISIONS - TM201xxx

REV	DESCRIPTION	DATE/BY	ECN NO.

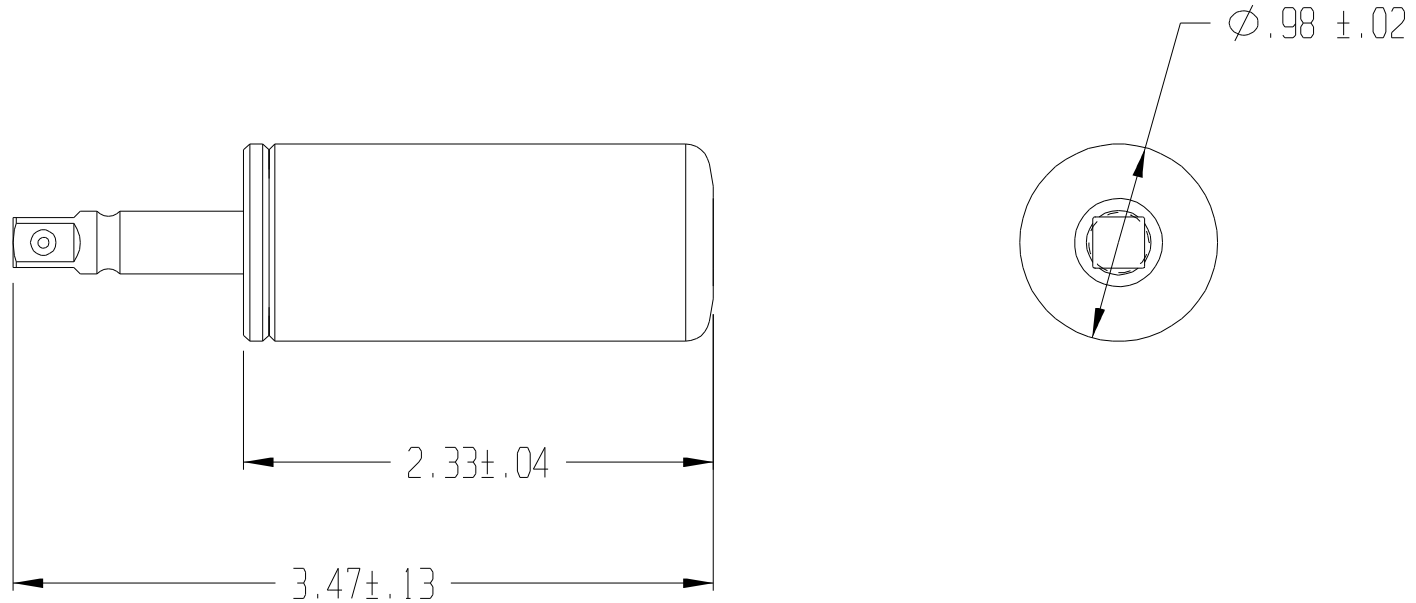

PRODUCT SPECIFICATIONS MUST BE FILLED IN AT TIME OF ORDER:

COMPLETE PART NUMBER: _____

TORQUE SETTING: _____ ±10% (35 LB-IN MAX)

COLOR OF HANDLE: _____

APPROVAL/DATE: _____

THIS DOCUMENT INCLUDING ALL DATA, SPECIFICATIONS, AND INFORMATION CONTAINED WITHIN IS CONFIDENTIAL AND PROPRIETARY TO BEERE PRECISION MEDICAL INSTRUMENTS, INC. BY RETENTION, THE RECIPIENT AGREES NOT TO REPRODUCE, DISCLOSE, OR MAKE USE OF ITS CONTENTS IN ANY WAY WITHOUT PRIOR WRITTEN PERMISSION OF AN OFFICER OF BEERE PRECISION MEDICAL INSTRUMENTS, INC.

MATERIAL	UNSPECIFIED TOLERANCES	BEERE PRECISION MEDICAL INSTRUMENTS, INC. 2503 LINCOLNWOOD CT., RACINE WI 53403 (262) 554-8505		
HEAT TREAT	.X +/- .020 ANGLE +/- 1° .XX +/- .010 MACHINE .XXX +/- .005 FINISH 32✓ .XXXX +/- .0005	TITLE PRESET IN-LINE TORQUE LIMITING ADAPTER		
FINISH	CONCENTRICITY .005 T. I. R. SQUARENESS .001 PER IN.	DO NOT SCALE DRAWING	SIZE SUPERSEDED NO	DWG NO
REMOVE ALL BURRS	BREAK SHARP CORNERS	JAR	11/01/97	TM201xxx
PART TO BE FREE OF DIRT, OIL, AND CONTAMINANTS		APPROVED	DATE	SCALE 1:1
				ILLUSTRATION SHEET 1 OF 1